

Split Phase Resilient Base Motors

Belt Drive and Blower Applications

Features: Class "B" Ins. • Continuous Duty • Energy Efficient \$ (see notes) • Open and TEAO
 • Reversible • Sleeve & Ball Bearing • 60 HZ (50 HZ per notes)



ARS2020L

SPLIT PHASE - NEMA AND UNITY SERVICE FACTOR

HP	RPM	F.L.			Frame	Stock			Approx. "C"	Dim.		Enclosure	Conn. Dia.	Notes
		Volts	Amps	S.F.		Number	Bearings	Protector		"AG"				
1/6	1725	115	4.0	1.35	48/56	GF2014	Sleeve	Auto	8.9	7	Open	39	1	
		115	4.0	1.35	48	RS2014L	Sleeve	None	8.9	7	Open	39		
		115	3.8	1.35	48Z	RB2014	Ball	Auto	9.3	7.3	Open	39	10	
1/4	1425	220	2.7	1.35	48	GF2025	Sleeve	Auto	9.4	7.5	Open	39	4	
		1725	115	5.5	1.0	48	GF2020L	Sleeve	None	8.9	7	Open	39	
	115	4.2	1.0	48	ARS2020L	Sleeve	None	9.4	7.5	TEAO	39	2		
		3.8	1.35	48/56	SC6024A	Sleeve	Auto	9.2	7.3	Open	104	1,3		
	115	4.6	1.35	48/56	GF2024	Sleeve	Auto	9.2	7.3	Open	39	1		
		4.6/2.3	1.35	48/56	GF2024D	Sleeve	Auto	9.2	7.3	Open	38	1		
	115/208-230	4.6/2.3	1.35	48/56	BF2024	Ball	Auto	9.2	7.3	Open	38	1,7		
		4.2	1.35	48	RB2024	Ball	Auto	9.4	7.5	Open	39			
	1140	115	5.3	1.00	56	ARS2026L	Sleeve	None	10.8	8.6	TEAO	39	2	
		115	5.3	1.35	56	RB2026L	Ball	None	10.8	8.6	Open	39		
	1/3	1425	220	3.2	1.35	48	GF2035	Sleeve	Auto	10.4	8.5	Open	39	4
1725			115	6.2	1.0	48	GF2030L	Sleeve	None	9.4	7.5	Open	39	
115		5.2	1.0	48	ARS2030L	Sleeve	None	9.9	8.0	TEAO	39	2		
		6.2	1.0	56Z	GF2031L	Sleeve	None	9.4	7.5	Open	39	8		
115		4.4	1.35	48/56	SC6034A	Sleeve	Auto	9.4	7.5	Open	104	1,3		
		5.9	1.35	48/56	GF2034	Sleeve	Auto	9.4	7.5	Open	39	1		
230		3.3	1.35	48	GF2038	Sleeve	Auto	9.4	7.5	Open	39	9		
		6.0/3.0	1.35	48/56	GF2034D	Sleeve	Auto	9.4	7.5	Open	38	1,9		
115/208-230		6.0/3.0	1.35	48/56	BF2034	Ball	Auto	9.4	7.5	Open	38	1,7,9		
		5.5	1.35	48	RS2034L	Sleeve	None	9.4	7.5	Open	39			
115		5.5	1.35	48	RB2034	Ball	Auto	9.4	7.5	Open	39			
	5.9	1.35	48	RB2034L	Ball	None	9.4	7.5	Open	39				

- Notes:**
 1. 48/56 FR = 1/2" x 1.5" Shaft with 5/8" shaft adapter - 48/56 slotted 3" height base
 2. TEAO gasketed conduit box - 3/4" extended thru bolts
 3. Energy efficient \$ - split phase start/capacitor run
 4. 50 cycle only
 7. 1/2" extended thru bolts, shaft end
 8. 56Z = 1/2" flat x 1.62" shaft, with 56 FR base
 9. Suitable for 208V at 1.0 S.F.
 10. 48Z = 1/2" flat x 1.88" shaft, with 48 FR base
 See page 159 for mounting dimensions

Continued on next page

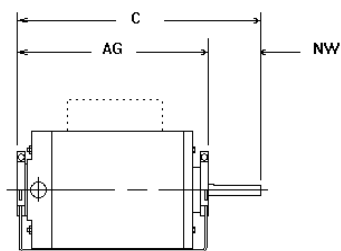

Shaft Dimensions
 48 = 1/2" Flat x 1-5/8"
 56 = 5/8" Keyed x 1-7/8"