

5" Diameter Double Shaft Fna/Blower Motors Less Base

Fan Coils - Dual Wheel Blower

Features

- Auto Protector
- CCWLE Rotation
- Open Construction
- Sleeve Bearing
- 1/2" Dia. - Flatted Shafts
- 60 HZ only
- 2-1/2" Dia. Rings
- 40° C Ambient
- 42 Frame (5.0" Dia.)



HP	RPM/ Speeds	Volts	Amps	Stock Number	Ring* Type	Dim. Ref.	Conn. Dia.	Notes
SHADED POLE								
1/20-1/25-1/30	1050/3	115	2.2	DCL6435	B	1	1	2
1/20-1/25-1/30	1050/3	115	2.2	DCL6434	B	1	1	1
1/15-1/20-1/25-1/30	1050/4	115	2.5	DCL6437	B	1	48	3
1/15-1/20-1/25	1050/3	115	2.2	DCL6436	B	1	1	2
1/10-1/15-1/25	1550/3	115	3.5	DCL4421	B	2	1	4
1/6-1/10-1/12-1/15	1550/4	115	4.0	DCL4422	B	3	48	3
PERMANENT SPLIT CAPACITOR/CAPACITOR MOUNTED (see notes)								
1/10-1/15-1/20	1075/3	277	.80	7DC6523	B	4	6	2,5
1/5-1/10	1550/2	208-230	2.8	DC4522	B	5	20	2,6
1/3	1625/1	208-230	2.3	DC4001	A	6	60	7,8

Notes:

1. 3/8" Shaft
2. 30" leads (minimum)
3. 24" leads (minimum)
4. 53" leads
5. 4 MFD, 370 VAC capacitor
6. 5 MFD, 370 VAC capacitor
7. Uses 6MFD, 370V capacitor, not included
8. 31" line leads, 5" capacitor leads

*For ring type. see page 155

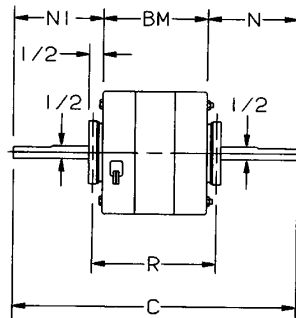

Approximate Dimensions

Ref.	BM	R	C	N1/N
1	2-7/8	3-9/16	24	10-9/16
2	3-5/16	4-1/16	18	7-5/16
3	3-7/8	4-9/16	18-1/4	7-3/16
4	4-1/16	4-13/16	20-11/16	8-5/16
5	3-9/16	4-5/16	24	10-3/16
6	4-1/8	4-11/16	18-1/2	7-3/16